

Size Reduction

Features

Construction:	Welded Mild Steel or Stainless Steel
Shaft:	Dual Rotating Shaft with Tooth Style Agitators
Air Purge:	Purged Shaft Seals and Bearings
Motor:	5 HP / 460 VAC / 3 Ø / 60 Hz
Operating Speed:	115 RPM
Operation:	Designed for Continuous Duty
Guarding:	Safety Guarding for all Pinch Points

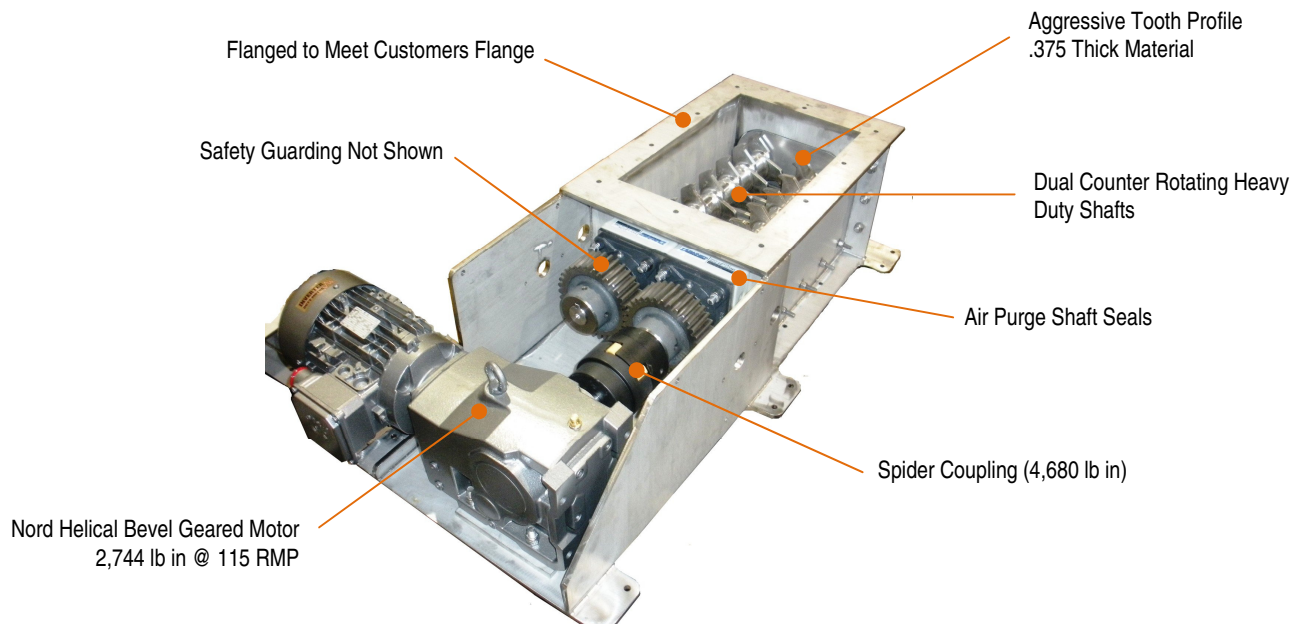

Equipment Description

The NBE Crumbler maintains a uniform flow of material to downstream processing equipment. Counter rotating shafts with staggered rotor blades deagglomerates materials as they pass through the stators in order to reduce materials to a conveyable partial size.

National Bulk Equipment

12838 Stainless Drive | Holland, MI 49424 | USA
616.399.2220 phone | 616.399.7365 fax
www.nbe-inc.com | sales@nbe-inc.com

Size Reduction

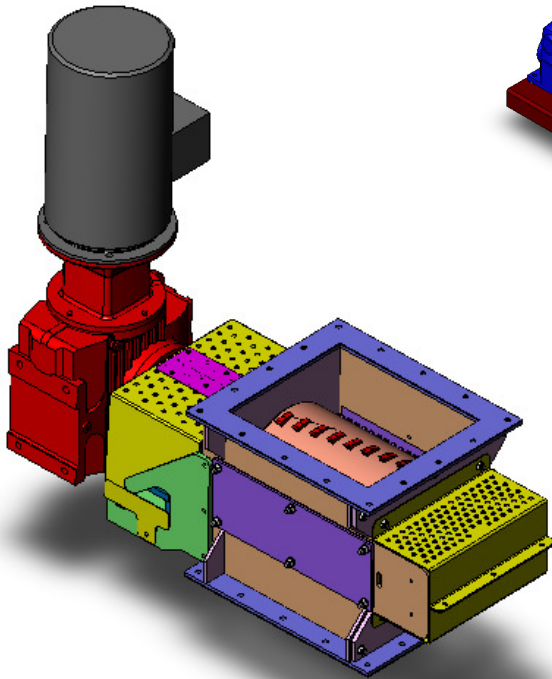
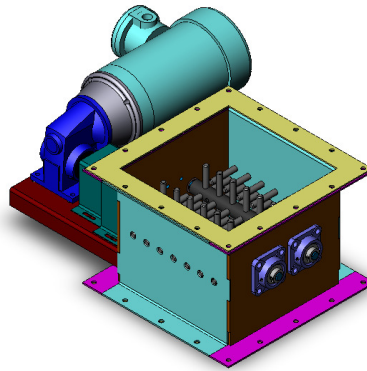
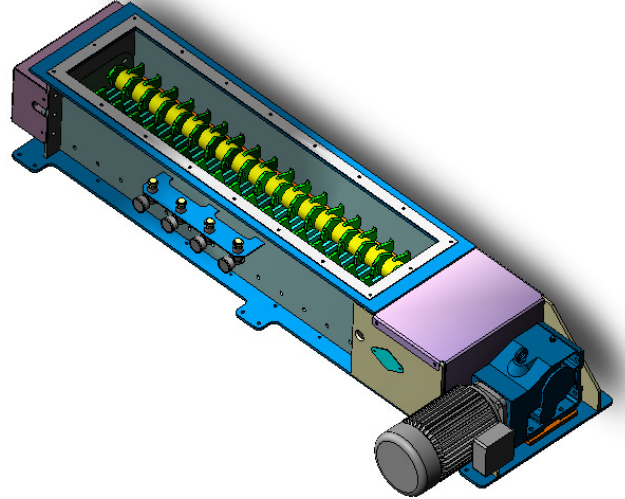
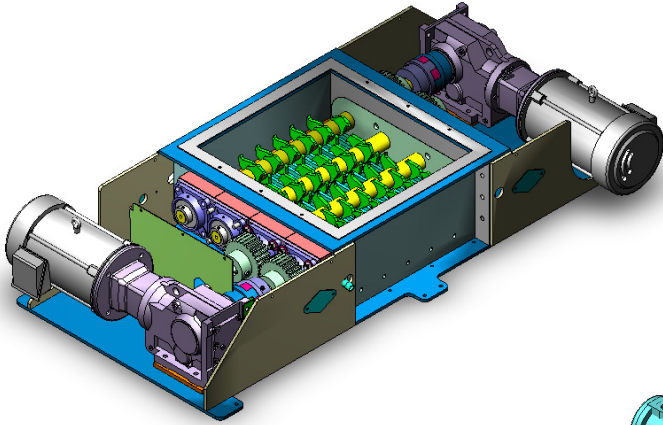

Crumblers are customer configurable for each specific application and may be integrated with auxiliary equipment

National Bulk Equipment
12838 Stainless Drive | Holland, MI 49424 | USA
616.399.2220 phone | 616.399.7365 fax
www.nbe-inc.com | sales@nbe-inc.com